

WallArt®

Wall Decor

ORIGINAL
BRAND

Installation Manual

Step 1



Let your panels acclimate for 48 hours

Step 2



Clean your wall, make it dry and free from grease & dust

Step 3



Cover your floor with a masking film or masking paper

Step 4



Measure and make a mark for your starting point

Step 5



Apply adhesive to all 4 sides of the back of your panel

Step 6

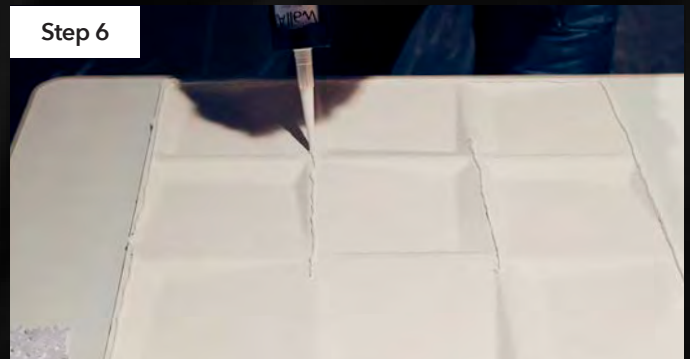

Apply 2 more vertical lines of adhesive where possible



Watch our installation video: www.mywallart.com/installation



Step 7

Install and apply equal pressure by using your fingertips



Step 8

Use a tile spacer to position each next panel

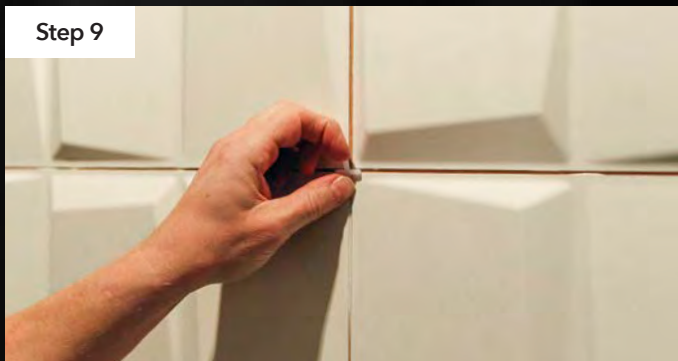

Step 9

Remove the tile spacer when surrounded by panels



Step 10

After each panel installed clean the joints using strong paper towel



Step 11

Spray or roll paint your wall (pay extra attention to the joints)



Step 12

After 24 hours apply a second layer of paint to your wall

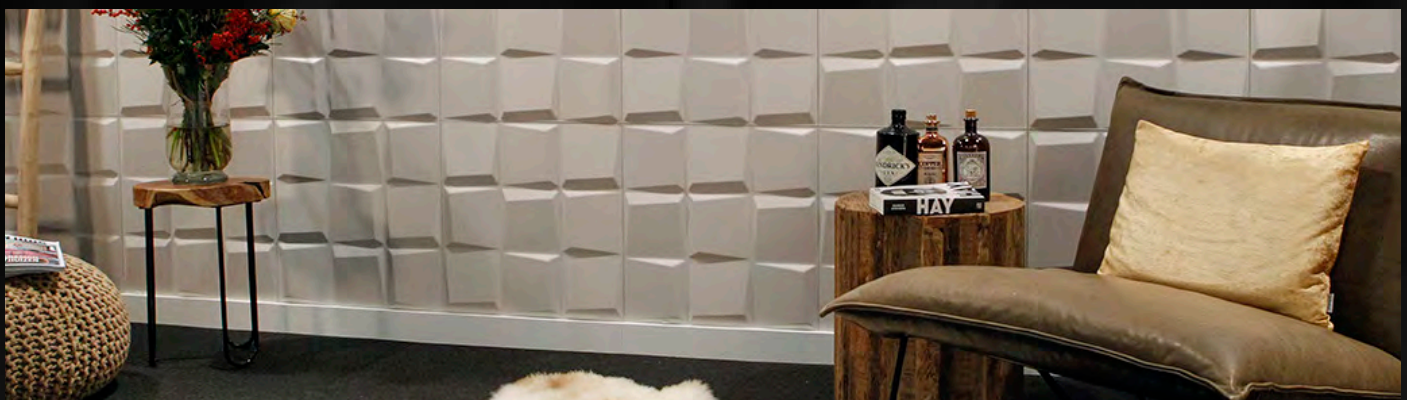

Watch our installation video: www.mywallart.com/installation